

Small Adjustable Shelf Support

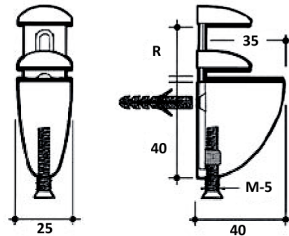

Manufactured from a strong zinc/ alloy, this clamp is suitable for shelving from 4mm to 24mm thick.

1mm x 5mm diameter hole in the back of the clamp makes for simple fixing to walls, the hole is elongated for easy vertical alignment.

Code	Description	Price
03-006	Bright Chrome Plated	\$ 9.15

Half Moon Shelf Supports

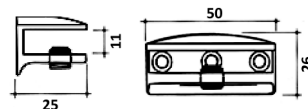

Half Moon 6

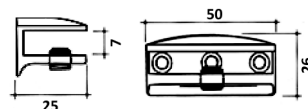

Half Moon 10

Suitable for shelving 4mm to 10mm thick.

3mm x 4mm diameter holes allow for strong fixing to walls, a small lip under the bracket gives extra support to reduce the risk of shelves "sagging". A grub screw from underneath secures shelving into the bracket.

Code	Description	Price
03-003	Bright Chrome Plated 4mm- 6mm	\$ 3.78*
03-004	Bright Chrome Plated 8mm- 10mm	\$ 3.78*

*Buy 100 \$ 3.00 each, Buy 50 \$ 3.50 each, Buy 10 \$ 3.78 each

Slim-Line Cylindrical Shelf Support

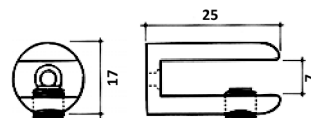

Slim-Line 6

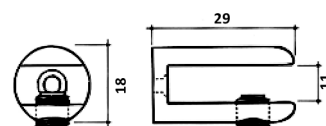

Slim-Line 10

Suitable for shelving 4mm to 10mm thick.

Designed for use where brackets can support two sides of the shelf. 1mm x 4mm diameter hole for fixing to wall.

Code	Description	Price
03-001	Bright Chrome Plated 4mm- 6mm	\$ 3.68
03-002	Bright Chrome Plated 8mm- 10mm	\$ 3.68