



X1U SERIES

TRADE HINGES RANGE

- ✓ High-quality manufactured hinges with durable finish
- ✓ Suits U-shape cut-out
- ✓ Suitable for 10 mm glass thickness

Hinges Capacities

Number of hinges on one door	Max. weight	Max. width
2	35kg	710mm
3	54kg	810mm

NFK Glazing
& Industrial Supplies

www.nfk.com.au

📍 28 Devlan Street,
Mansfield, QLD 4122

☎ 07 3343 3377

✉ sales@nfk.com.au

📍 42 Tacoma Circuit,
Canning Vale, WA 6155

☎ 08 9455 3866

✉ wasales@nfk.com.au

X1U Wall to Glass 90° Offset Back Plate

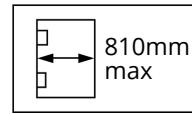
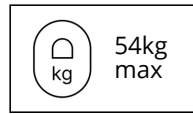
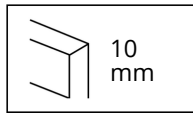
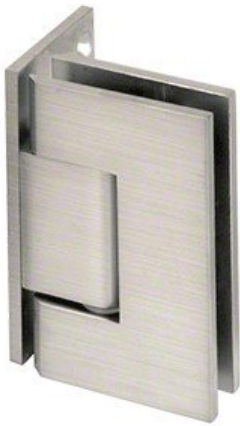

- High-quality square wall-to-glass hinge 90° with offset back plate
- Recommended wall-to-glass clearance - 8mm

FINISH	CODE
Chrome	19-SH/024C
Matt Black	19-SH/024MB
Brushed Nickel	19-SH/024BN
Brushed Gold	19-SH/024BG
Other finishes	Contact NFK

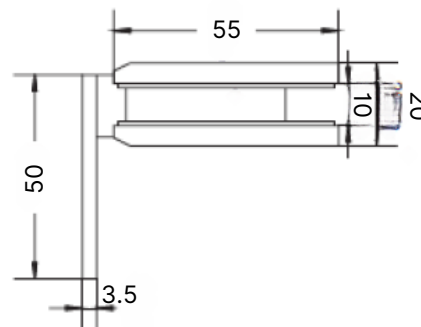
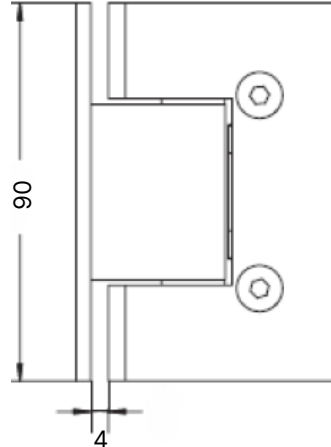
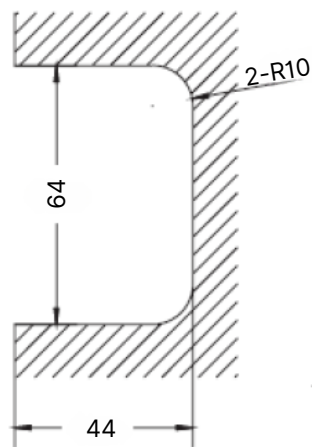

NFK Glazing
& Industrial Supplies

www.nfk.com.au

28 Devlan Street,
Mansfield, QLD 4122

07 3343 3377

sales@nfk.com.au

42 Tacoma Circuit,
Canning Vale, WA 6155

08 9455 3866

wasales@nfk.com.au