

U Channel Extrusion

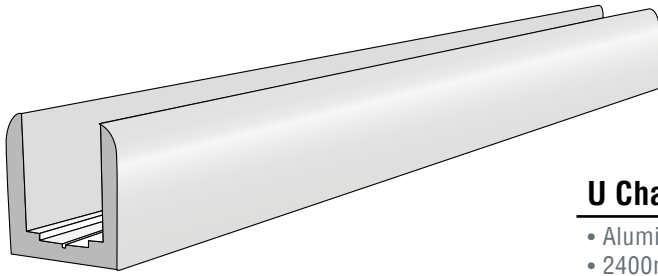

**U Channel Extrusion**

- Aluminium Chrome 8mm-10mm
- 2400mm length

Description	Code
Chrome	19-SH/017

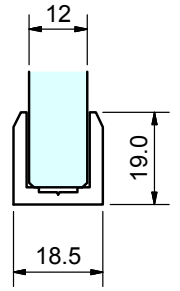

Water Bar

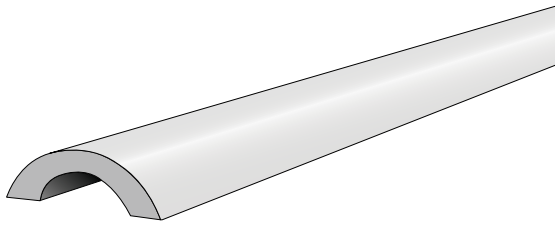

**Water Bar D Profile**

- Chrome finished aluminium water bar
- 20mm wide x 6mm high curved profile with rebated base for silicone
- Also available in 900mm lengths

Description	Code
20mm x 2400mm Chrome	19-SH/001
12mm x 2500mm Chrome	19-SH/000

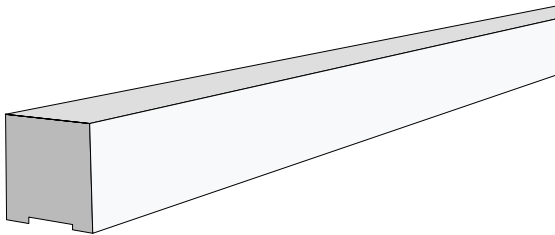
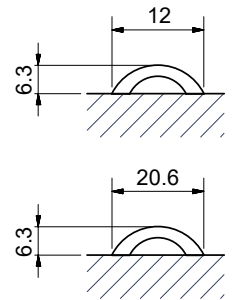

**Water Bar Square Profile**

- Chrome finished aluminium water bar
- 10mm x 10mm x 3metre

Description	Code
Square 10x10x3000 Chrome	19-SH/000.01

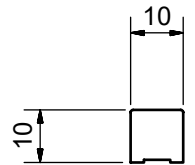

Waterseals

**Waterseals**

- NFK stock waterseals to suit glass 6mm, 8mm, 10mm and 12mm thick
- 2400mm length

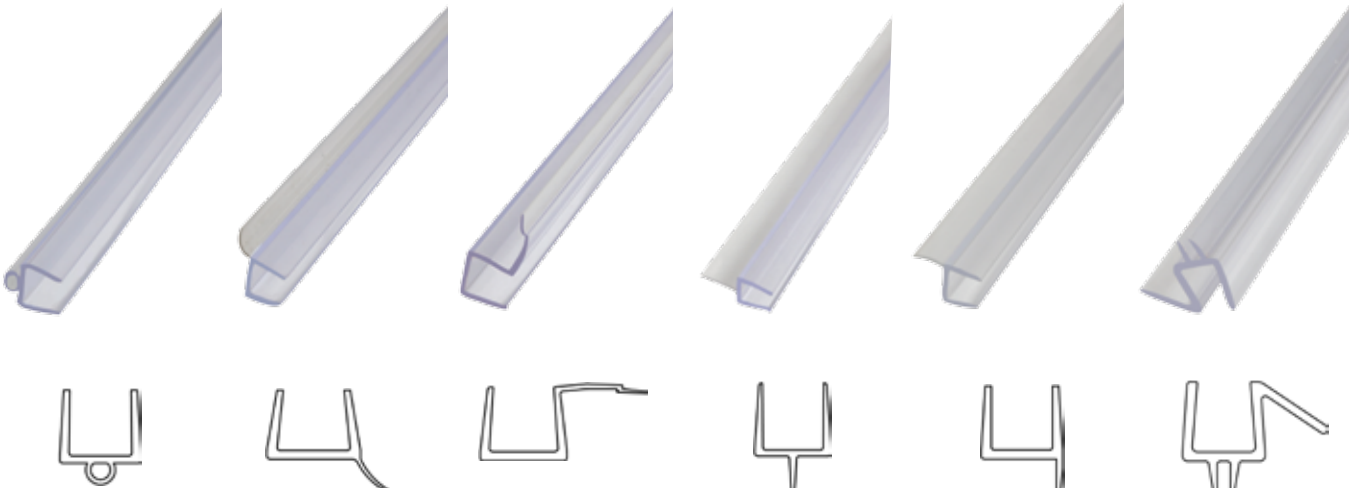

Size	Code	Size	Code	Size	Code	Size	Code	Size	Code	Size	Code
6mm	19-SH/0085	6mm	-	6mm	-	6mm	19-SH/0065	6mm	19-SH/0115	6mm	19-SH/0035
8mm	-	8mm	-	8mm	-	8mm	-	8mm	-	8mm	19-SH/0032
10mm	19-SH/008	10mm	19-SH/002	10mm	19-SH/009	10mm	19-SH/006	10mm	19-SH/011	10mm	19-SH/003
12mm	19-SH/0087	12mm	-	12mm	-	12mm	19-SH/0067	12mm	19-SH/0117	12mm	19-SH/0037