



Glass Lifting & Handling Equipment | DSMH2 - 12V-1500

Kappel Vacuum Lifter DSMH2 - 12V-1500



- The Kappel DSMH2 is designed and engineered for extreme glass lifting and applications where the operator cannot access the rig during lifting, manoeuvring and detachment
- Quick-release couplings for vacuum cups and slotted frame design allows for easy configuration of cups, to suit any lifting requirements
- In addition, it's possible to attach custom-made sub-frames to the main slotted frame in order to lift large sheets, curved glass, odd-shaped panels etc
- High-quality electrical components give precision control of tilt and rotate functions
- The rig comes standard with dual vacuum loops and includes with "blow off" for fast and easy release. Both cabled and wireless remotes are available
- Supplied on a lightweight trolley

Technical characteristics

Suction pads/cups: 20 pieces, type 150K

Dual circuit system: 2 vacuum circuits, independent of each other

Extensions: 6 pieces

Lift Capacity: 750 kg with 10 suction cups, without extensions
1500 kg with 20 suction cups, with 6 extensions

Total Rig Weight: approx. 380 kg

Tilt: 90° hydraulic

Rotate: 360° electric

Two vacuum plumps: 12V, DC, nominal current approx. 4A/pump

Power supply: Two batteries: nominal voltage - 12V, DC, nominal capacity - 26Ah
main voltage - 230V, AC; 50Hz

- Features:
- The voltage indicator shows the battery charge level
 - The vacuum display shows the current vacuum level
 - Acoustic warning signal
 - Adjustable lifting eye

NFK Glazing
& Industrial Supplies

www.nfk.com.au

28 Devlan Street,
Mansfield, QLD 4122

07 3343 3377

sales@nfk.com.au

42 Tacoma Circuit,
Canning Vale, WA 6155

08 9455 3866

wasaless@nfk.com.au

DRAWINGS

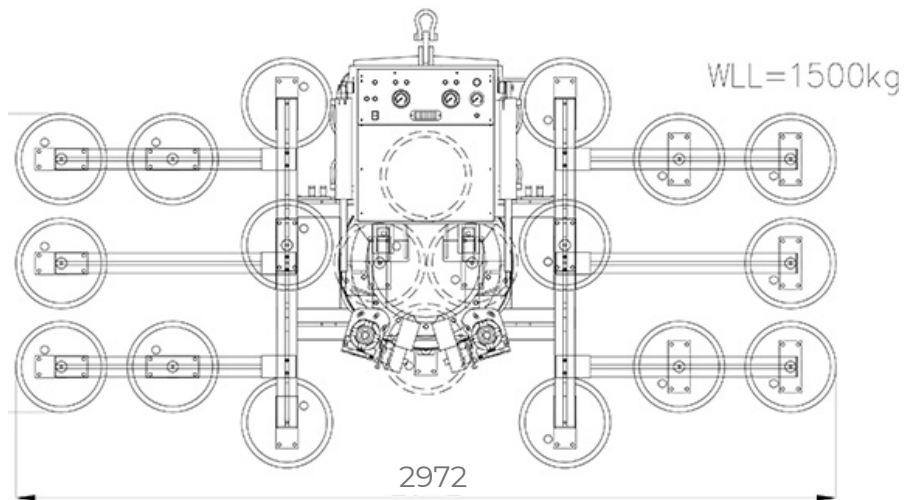
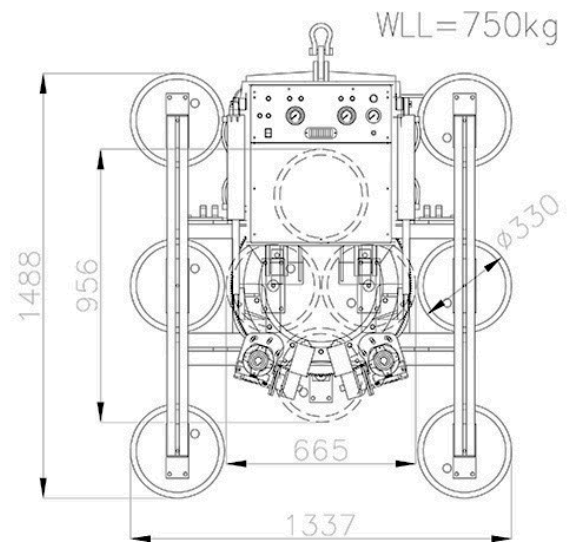
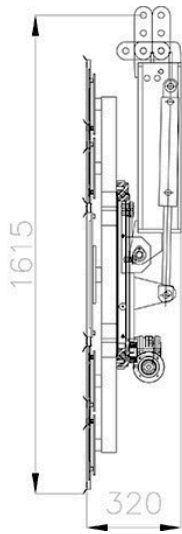

NFK Glazing
& Industrial Supplies

www.nfk.com.au

📍 28 Devlan Street,
Mansfield, QLD 4122

☎ 07 3343 3377

✉ sales@nfk.com.au

📍 42 Tacoma Circuit,
Canning Vale, WA 6155

☎ 08 9455 3866

✉ wasales@nfk.com.au